

TYPICAL STEPPED FOUNDATION - BEFORE CONCRETE POUR

NOTE:
 DETAILS SHOWN ARE INDICATIVE ONLY
 AND SUBJECT TO FINAL ENGINEERS DESIGN

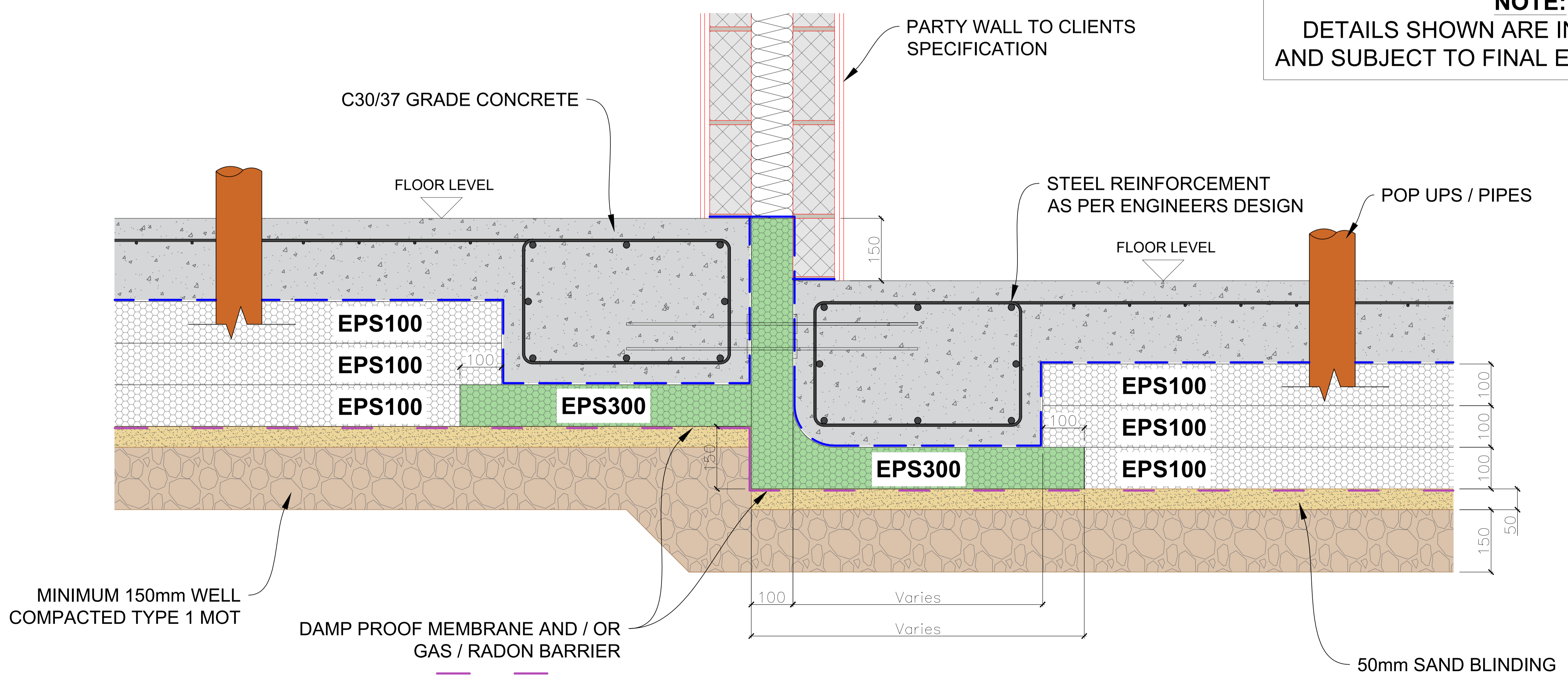

TYPICAL STEPPED FOUNDATION - AFTER CONCRETE POUR

Drawing Title:
**FUTURE FOUND
 INSULATED RAFT
 FOUNDATION SYSTEM**
**TYPICAL STEPPED
 FOUNDATION DETAIL**

Drawing Number: FF-SF-01	Revision: 0
Drawn by: JJB	Date: 26/02/2025
Page Size: A1	



Build-Lite (UK) Ltd
 Kingsforth Road, Thurcroft
 Rotherham, S66 9HU

www.build-liteuk.co.uk
 01709 242210

