

FUTURE FOUND INSULATED FOUNDATION SYSTEM TYPICAL INSTALLATION GUIDE FOR STANDARD L-SHAPE EDGE PROFILE



IMPORTANT: PRIOR TO PERIMETER EPS300 PROFILE BEING POSITIONED THE CONTRACTOR NEEDS TO ENSURE THAT THE REQUIRED SERVICES , DRAINAGE OR DUCTWORK ARE ALREADY IN POSITION . THE ENTIRE AREA UNDER THE FOUNDATION NEEDS TO BE LEVEL AND ALSO HAVE A MINIMUM OF 150mm WELL COMPACTED HARDCORE WITH SAND BLINDING IN PLACE. THE DPM/RADON BARRIER IS TO BE IN POSITION THEREFORE PLEASE CHECK WITH THE PROJECT DRAWINGS & SECTIONS FOR CORRECT PLACEMENT, OR CONTACT BUILD-LITE FOR ADVICE.

STAGE : 1

PERIMETER PROFILE EPS 300

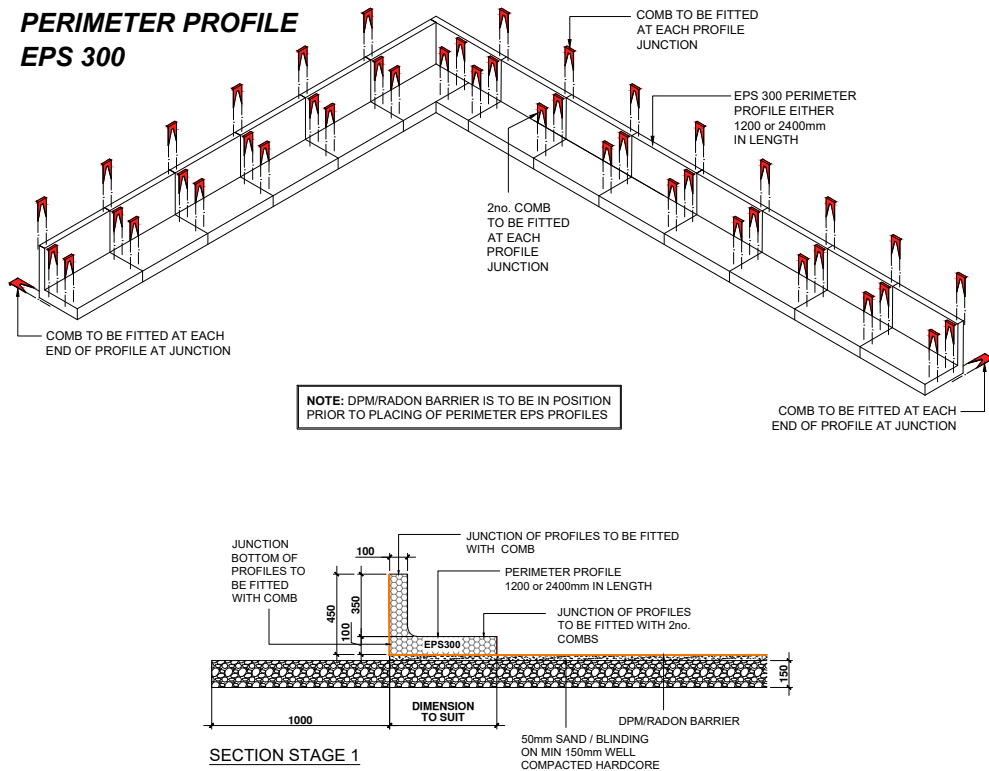

STAGE : 2

INTERNAL LOAD BEARING WALLS - EPS 300

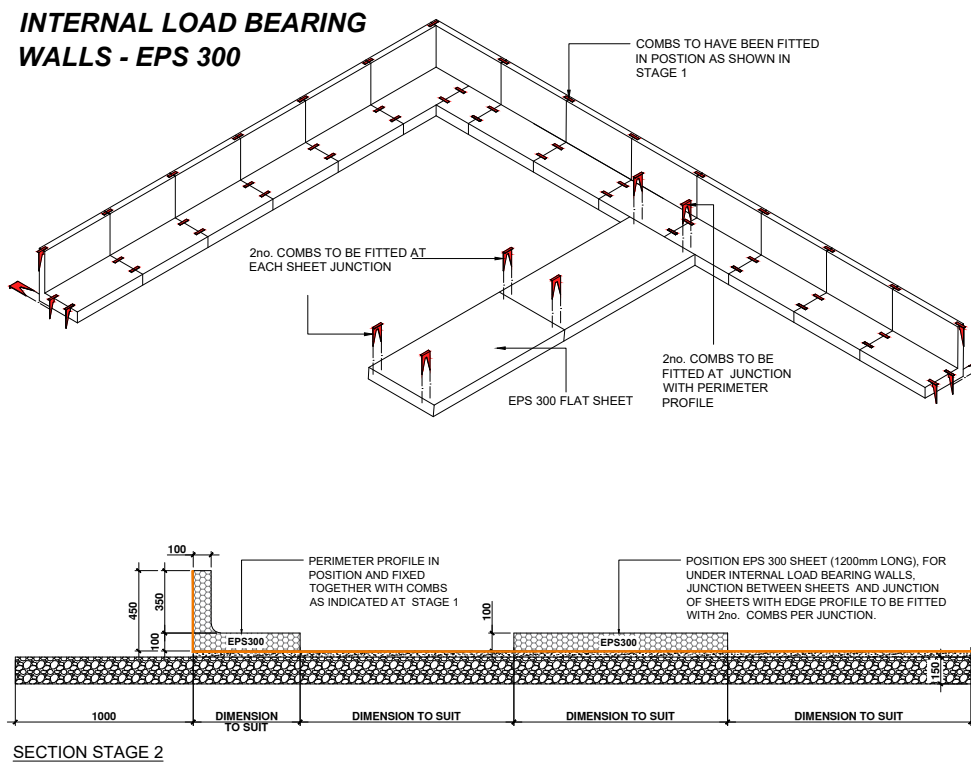

STAGE : 3

LAYER 1 - EPS 100

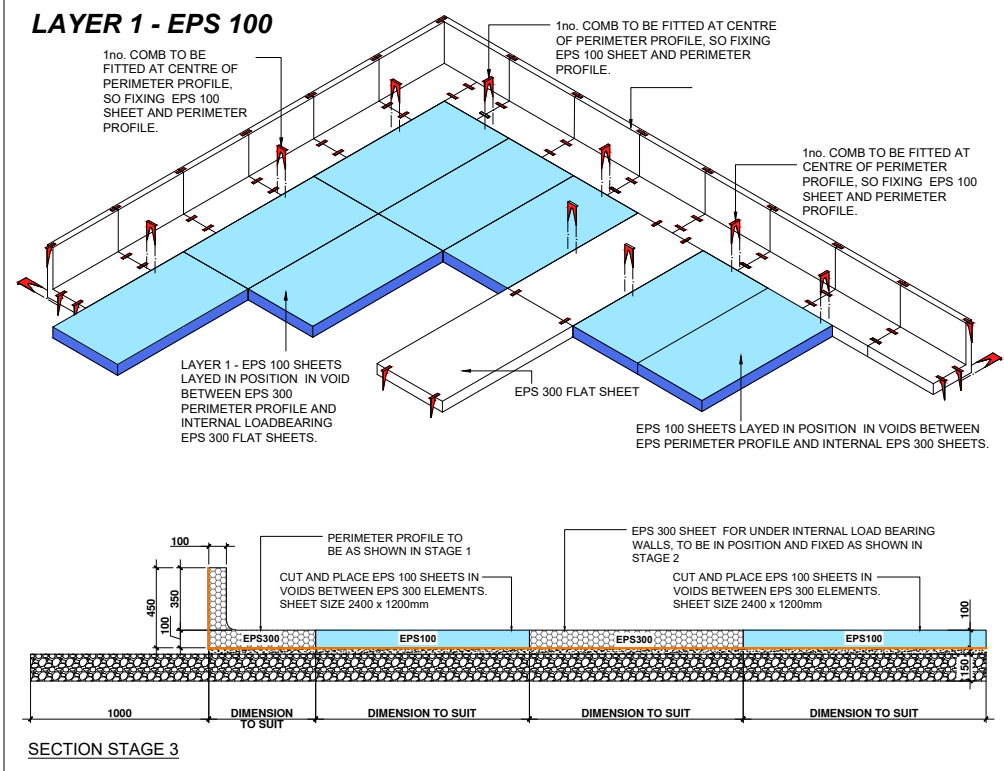

STAGE : 4

LAYER 2 - EPS 100

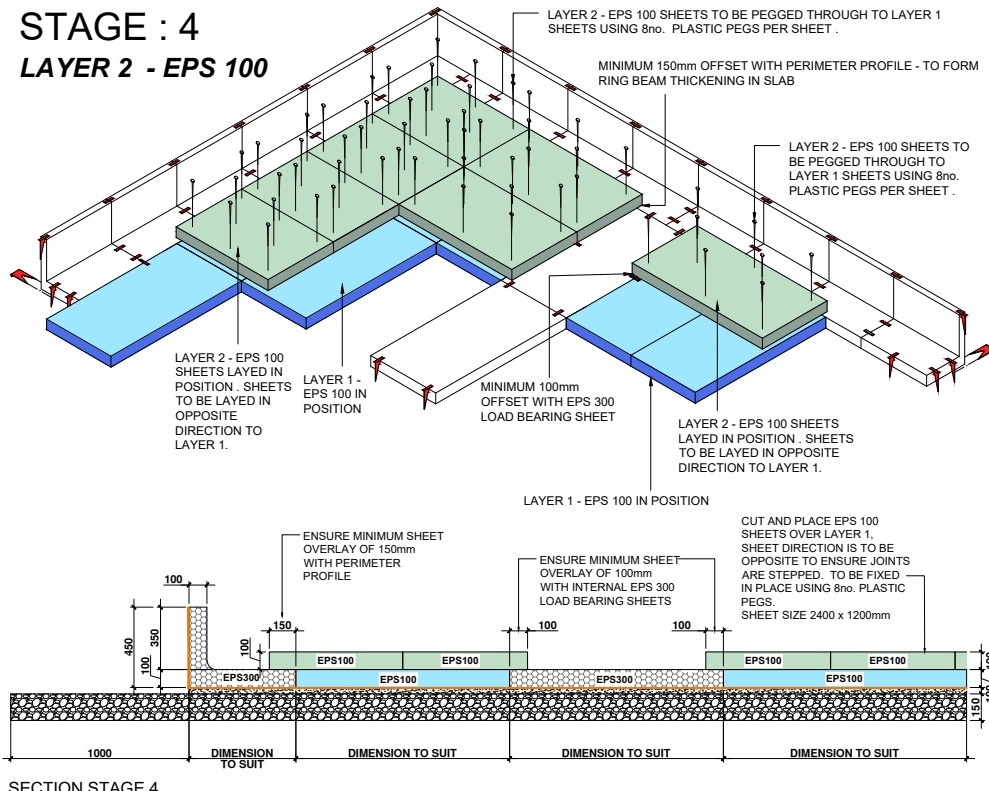

STAGE : 5

LAYER 3 - EPS 100

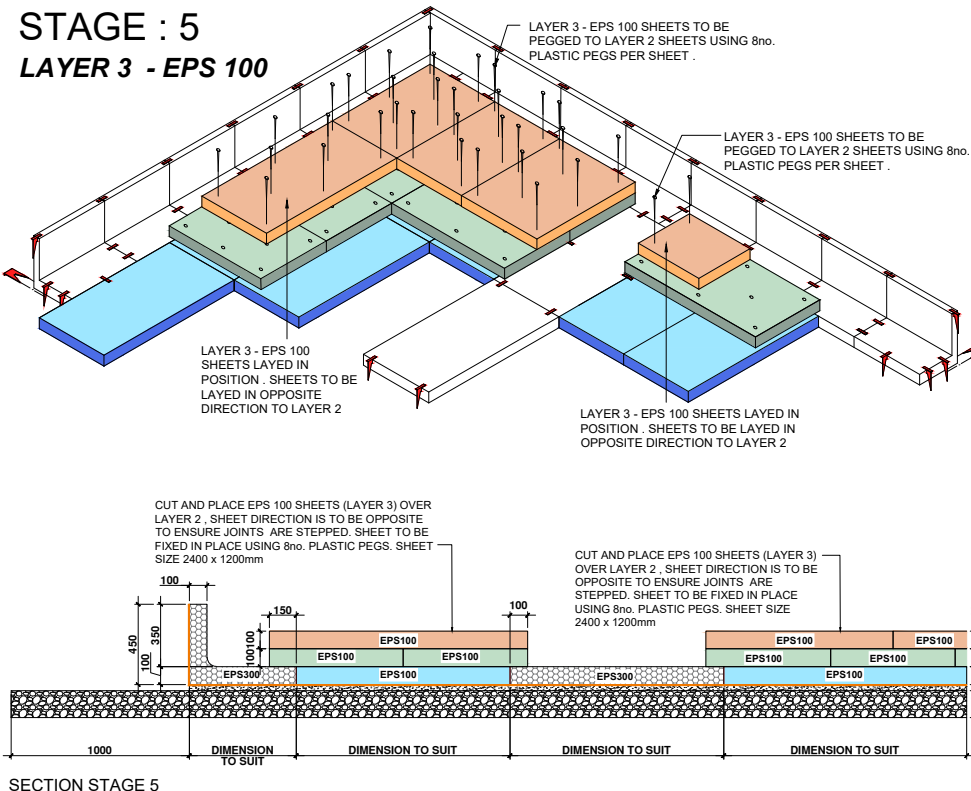

STAGE : 6

EPS FORMWORK COMPLETE

